



# Deptford Parks Liveable Neighbourhood

## CONSULTATION AREA

### 6 - Continuous Footway



Working in partnership with:

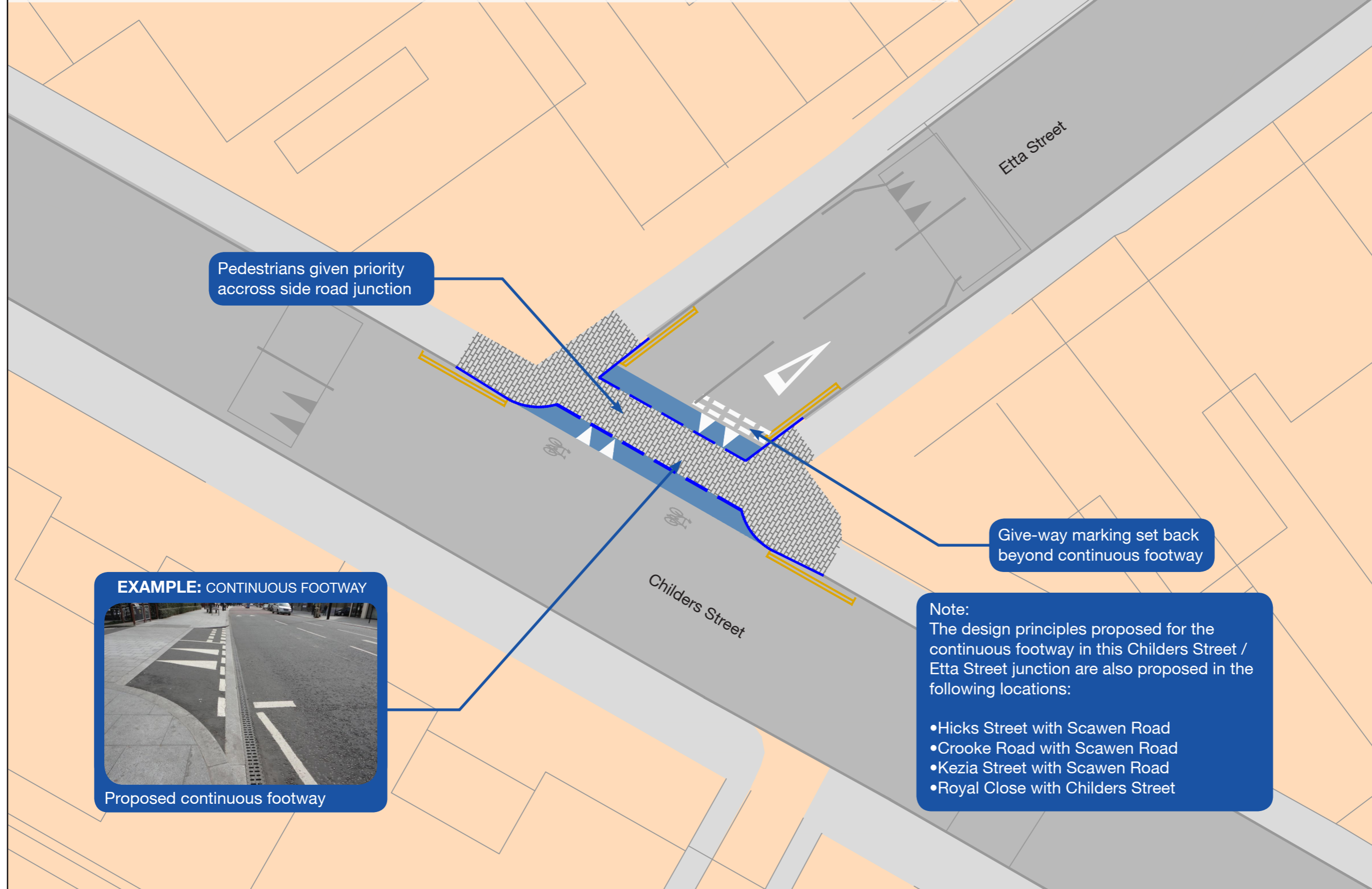

Key:	
	Outside of project scope
	Proposed continuous footway
	Existing carriageway
	Existing footway
	Existing line markings
	Proposed white line markings
	Existing kerb
	Proposed kerb
	Proposed flush kerb
	Proposed yellow line markings

**EXAMPLE: CONTINUOUS FOOTWAY**



Proposed continuous footway

Give-way marking set back beyond continuous footway

**Note:**  
 The design principles proposed for the continuous footway in this Childers Street / Etta Street junction are also proposed in the following locations:

- Hicks Street with Scawen Road
- Crooke Road with Scawen Road
- Kezia Street with Scawen Road
- Royal Close with Childers Street